

1 TYPICAL LOAD-BEARING CONCRETE MASONRY UNIT (CMU) SECTIONS AND DETAILS SCALE: N.T.S.

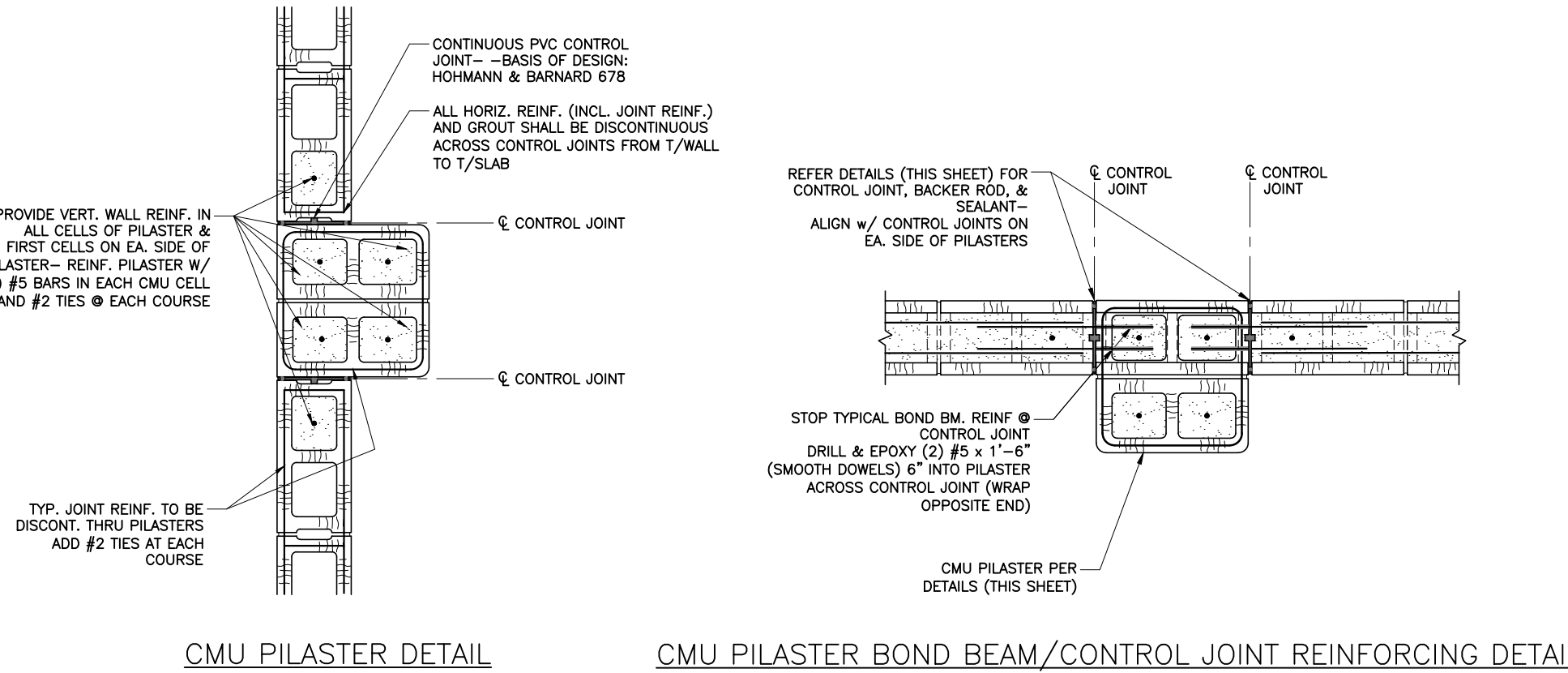

1 TYPICAL LOAD-BEARING CONCRETE MASONRY UNIT (CMU) SECTIONS AND DETAILS - CONTINUED SCALE: N.T.S.

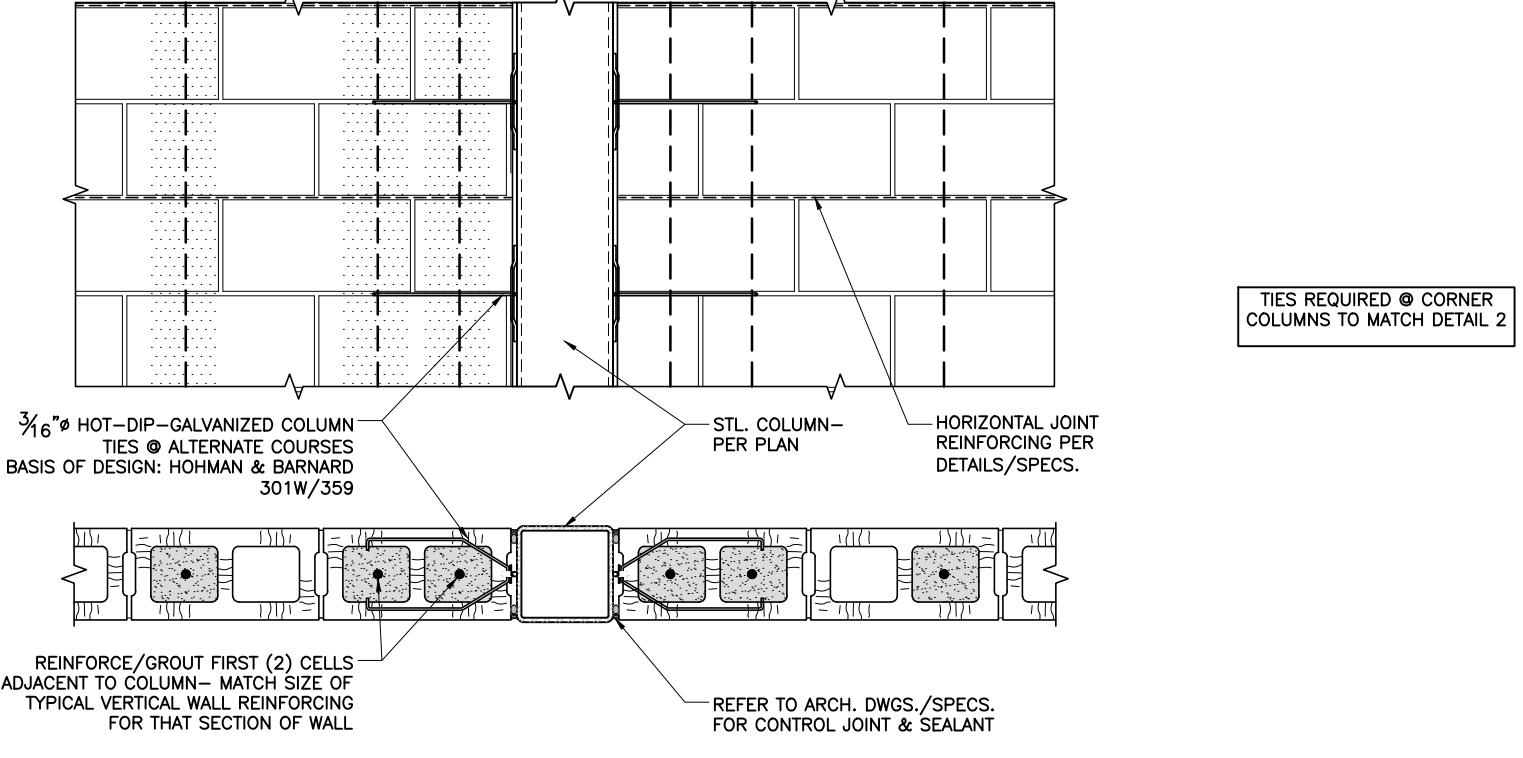

2 TYPICAL MASONRY TIE DETAILS AT CMU WALL AND STEEL COLUMN SCALE: N.T.S.

RMG ARCHITECT

RANDY M. GOODLOE, AIA, APAC
725 KIRBY STREET
LAKE CHARLES, LOUISIANA

OFFICE: 337.436.3036
FAX: 337.436.3773



NEW CONSTRUCTION

FORD PRO

FOR

MIKE WILLIS

2010 PATTON STREET, SULPHUR, LA 70665

© COPYRIGHT 2026, RANDY M. GOODLOE, A.I.A. APAC. ALL INFORMATION, EITHER DRAWN, WRITTEN, OR IMPLIED APPEARING IN THIS DOCUMENT SHALL NOT BE DUPLICATED, DISCLOSED, OR OTHERWISE USED WITHOUT THE WRITTEN PERMISSION OF THE AUTHOR, RANDY M. GOODLOE, AIA APAC. THIS DOCUMENT IS AN INSTRUMENT OF SERVICE AND IS THE SOLE PROPERTY OF THE AUTHOR. FURTHERMORE, THE USE OF THIS DOCUMENT FOR ANY PURPOSE SHALL BE REVOKED, IF THE INTENT OF THE DESIGN OR THE CONSTRUCTION TECHNIQUES OR DETAILS SHOWN HEREIN ARE NOT ADHERED TO OR THE CONTRACTUAL AGREEMENT GOVERNING THEIR USE ARE NOT STRICTLY ADHERED TO.

RMG PROJECT NO. 25012

PROJECT MANAGER TM

DATE ISSUED 05/22/2026

S-102

TYPICAL CONCRETE MASONRY UNIT DETAILS AND SECTIONS

DUHON + PLEASANT

CIVIL & STRUCTURAL ENGINEERS